

Construction Set to Begin Next Week at New Apple Valley Transit Station

Construction is expected to begin next week at the west side of the site of the new Apple Valley Transit Station (by April 15). Activity has already been taking place on the east side of the site. When this next phase of construction begins, riders will be moved to the east side of the former Watson's parking lot.

Entrance to the parking will be on 155th St., east of the current entrance. This area will be used for rider parking throughout the construction.

We understand that this will be disruptive and not as convenient for boarding the bus, but we are excited about constructing the new transit station that will service our existing riders as well as prepare for the Bus Rapid Transit (BRT) scheduled for 2010 or 2011.

The temporary parking area will not have an asphalt surface, but rather will be gravel. There will be no lines to delineate specific parking spots, but there will be chains and poles to indicate rows for parking. (See drawing on reverse.) The bus stop will be closed beginning Monday, April 13, and all riders should plan to board/alight the bus at the Apple Valley Transit Station. Additional handicapped spaces will be created at the existing Transit Station site to accommodate riders with disabilities during the construction period.

Construction is expected to continue through the summer and into the fall with the new site opening in December.

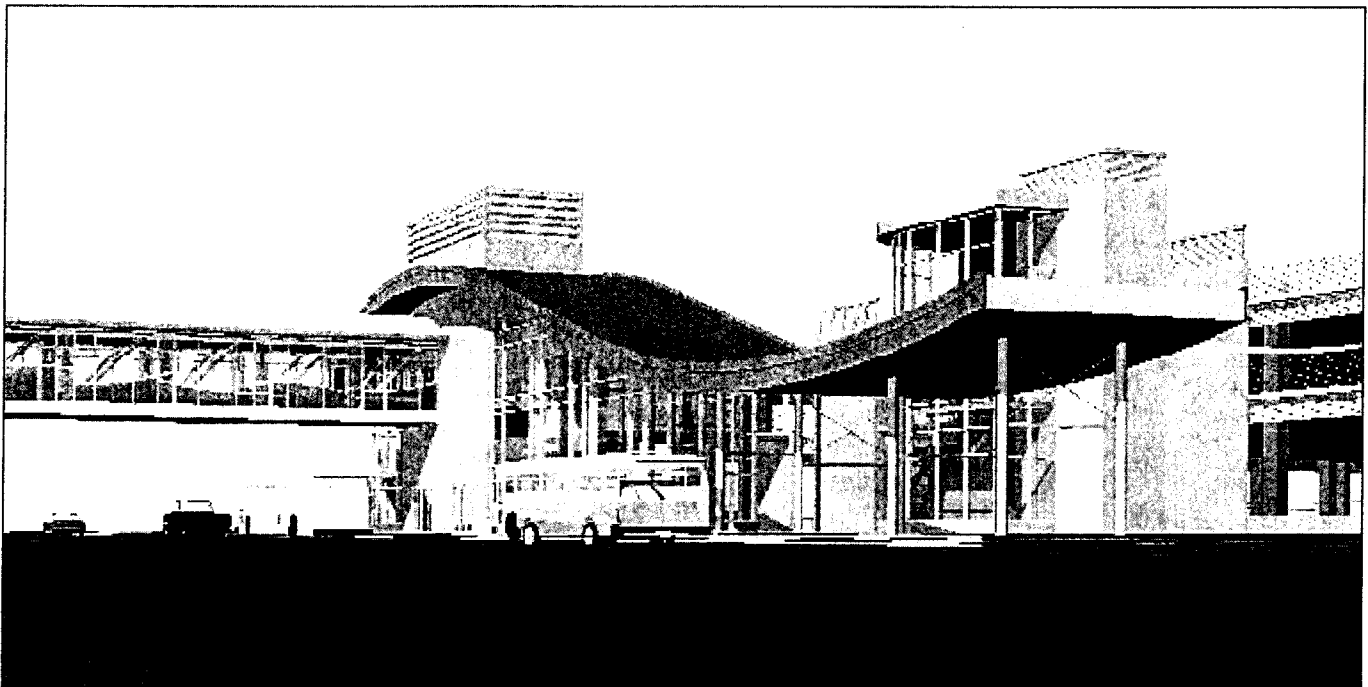

Park in area below in spaces defined by poles and chains. There should be parking for more than 300 vehicles. All handicapped parking will be at the Apple Valley Transit Station during the construction of the new site.

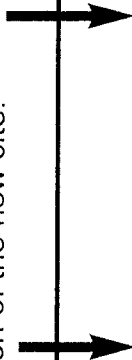

**This section
of parking lot
will be closed**

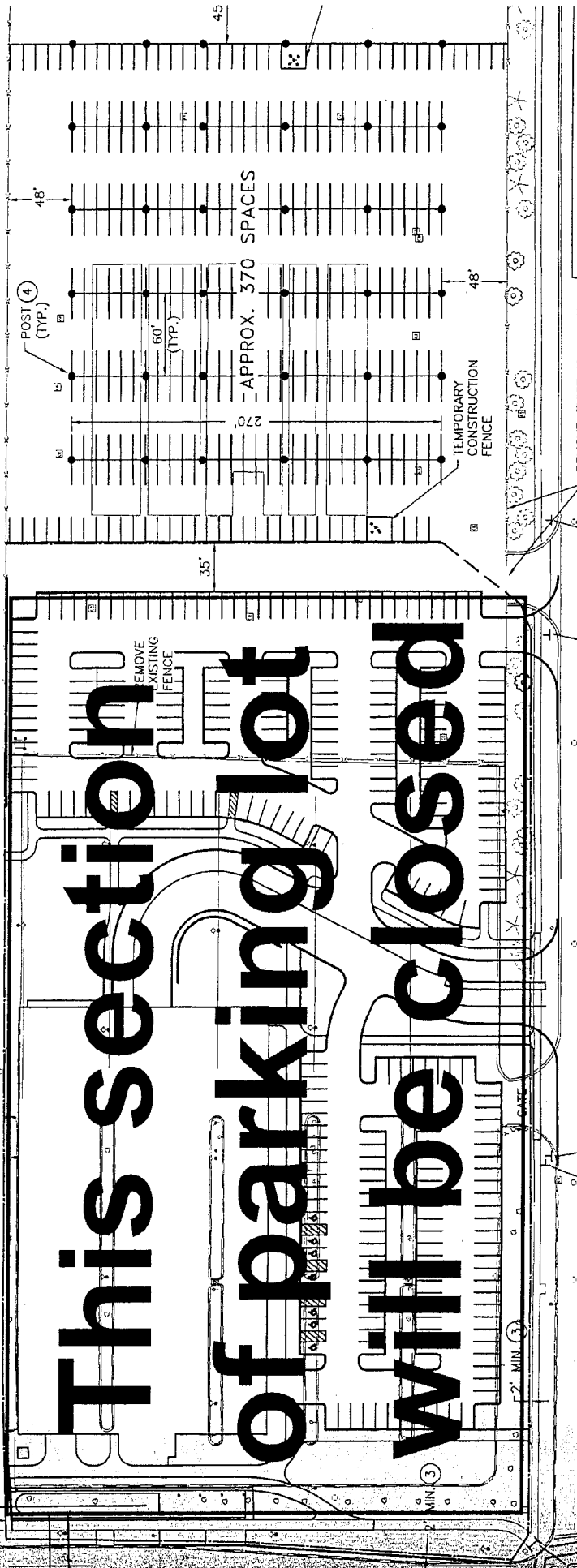

155TH STREET